



Malli F1205

DIN 327D HSSCO8%

- 2-leikkuinen Z2
- Poraava
- Weldon varsi
- Urajyrsintä
- Viimeistely
- Leikkumuoto
- Normi
- Nousukulma
- Leikkukulma



N
DIN 327D
30°
12°

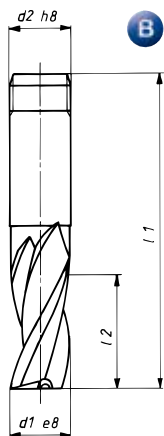

Malli F1305

DIN 844B HSSCO8%

- 3-leikkuinen Z3
- Poraava
- Weldon varsi
- Urajyrsintä
- Viimeistely
- Leikkumuoto
- Normi
- Nousukulma
- Leikkukulma



N
DIN 844B
30°
12°

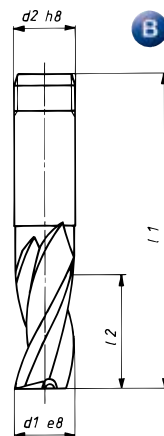

Tuotenro:	d1 mm	d2 mm	l2 mm	l1 mm	€ Alv 0%
F1205-1,5	1,5	6	3,0	47,0	16,50
F1205-2	2,0	6	4,0	48,0	11,70
F1205-2,5	2,5	6	5,0	49,0	13,00
F1205-3	3,0	6	5,0	49,0	11,70
F1205-3,5	3,5	6	6,0	50,0	13,00
F1205-4	4,0	6	7,0	51,0	11,70
F1205-4,5	4,5	6	7,0	51,0	13,00
F1205-5	5,0	6	8,0	52,0	11,70
F1205-5,5	5,5	6	8,0	52,0	13,00
F1205-6	6,0	6	8,0	52,0	11,70
F1205-6,5-8	6,5	8	10,0	54,0	19,30
F1205-7-8	7,0	8	10,0	54,0	19,30
F1205-7,5-8	7,5	8	11,0	55,0	20,60
F1205-8-8	8,0	8	11,0	55,0	14,70
F1205-8,5	8,5	10	11,0	61,0	23,40
F1205-9	9,0	10	11,0	61,0	22,30
F1205-10	10,0	10	13,0	63,0	17,80
F1205-11	11,0	12	13,0	70,0	28,30
F1205-12	12,0	12	16,0	73,0	23,40
F1205-13	13,0	12	16,0	73,0	34,20
F1205-14	14,0	12	16,0	73,0	28,30
F1205-15	15,0	12	16,0	73,0	35,10
F1205-16	16,0	16	19,0	79,0	33,10
F1205-17	17,0	16	19,0	79,0	47,20
F1205-18	18,0	16	19,0	79,0	39,70
F1205-19	19,0	16	19,0	79,0	60,80
F1205-20-20	20,0	20	22,0	88,0	45,40
F1205-22	22,0	20	22,0	88,0	58,70
F1205-24	24,0	25	26,0	102,0	82,10
F1205-25	25,0	25	26,0	102,0	69,70
F1205-26	26,0	25	26,0	102,0	104,80
F1205-28	28,0	25	26,0	102,0	115,00
F1205-30	30,0	25	26,0	102,0	129,00
F1205-32-32	32,0	32	32,0	112,0	141,00
F1205-36	36,0	32	32,0	112,0	165,00
F1205-40-40	40,0	40	38,0	130,0	230,00

Tuotenro:	d1 mm	d2 mm	l2 mm	l1 mm	€ Alv 0%
F1305-2	2,0	6	7,0	51,0	17,30
F1305-3	3,0	6	8,0	52,0	16,40
F1305-4	4,0	6	11,0	55,0	16,40
F1305-5	5,0	6	13,0	57,0	16,40
F1305-6	6,0	6	13,0	57,0	18,80
F1305-7-8	7,0	8	16,0	60,0	26,00
F1305-8-8	8,0	8	19,0	63,0	23,30
F1305-9	9,0	10	19,0	69,0	32,00
F1305-10	10,0	10	22,0	72,0	26,70
F1305-11	11,0	12	22,0	79,0	35,70
F1305-12	12,0	12	26,0	83,0	34,70
F1305-13	13,0	12	26,0	83,0	45,00
F1305-14	14,0	12	26,0	83,0	43,40
F1305-15	15,0	12	26,0	83,0	47,20
F1305-16	16,0	16	32,0	92,0	45,00
F1305-17	17,0	16	32,0	92,0	62,00
F1305-18	18,0	16	32,0	92,0	60,40
F1305-19	19,0	16	32,0	92,0	74,50
F1305-20	20,0	20	38,0	104,0	71,00
F1305-22	22,0	20	38,0	104,0	87,00
F1305-24	24,0	25	45,0	121,0	107,00
F1305-25	25,0	25	45,0	121,0	113,00
F1305-26	26,0	25	45,0	121,0	125,00
F1305-28	28,0	25	45,0	121,0	147,00
F1305-30	30,0	25	45,0	121,0	175,00
F1305-32-32	32,0	32	53,0	133,0	199,00