

# JDN RATCHET HOISTS WITT

Carrying capacities: 1.5 t, 2.5 t

The **WITT** is designed for for lifting, pulling, tensioning or anchoring operations under all working positions. It has a robust cast iron housing and is extremely resistant to adverse working conditions. Technically the **WITT** distinguishes itself by a totally enclosed planetary gear. All rotating parts have ball, needle or slide bearings.

The **WITT** is a proven device for moving and positioning heavy machinery, for tensioning heavy loads during transport, for positioning various heavy profiles and for many other operations.



## TECHNICAL DATA

Type		WITT 1,5t	WITT 2,5t
Carrying capacity	mt	1.5	2.5
Number of falls		1	
Lift per ratchet rotation	inch. mm	1.3 33	1.5 37
Lever force at full load	lbs kg	61.7 28	88.2 40
Weight without chain	lbs kg	16.5 7.5	39.7 18
Total weight	lbs kg	20.3 9.2	48.5 22
Weight of 1 m chain	lbs kg	2.2 1	6.0 2.7
Chain dimension	mm	7.1 x 21	11 x 31
Standard lift	ft m	59.1 1.5	

## DIMENSIONS

Type		WITT 1,5t	WITT 2,5t
A smallest headroom	inch. mm	13.6 345	17.3 440
B	inch. mm	6.3 160	7.3 185
C	inch. mm	2.6 65	2.8 72
D	inch. mm	3.7 93	5.5 140
E	inch. mm	1.1 27	1.2 31.5
F	inch. mm	14.4 365	15.6 395
G	inch. mm	3.7 95	5.2 133
H	inch. mm	2.4 62	3.5 88

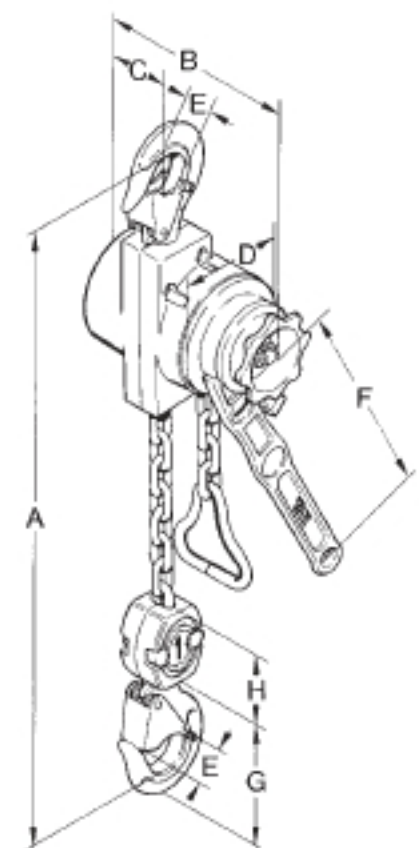

**J.D. NEUHAUS**  
powered by air!