

# JDN AIR HOISTS MINI



## The mini series at a glance



Energy supply  
(spiral hose)



Manual trolleys

Special grease for  
oil-free operation



mini in manipulator version

Galvanised chain  
3 standard lifting heights

Sensitive control  
3 standard control lengths

Explosion classification  
II 3 GD II A T4

Mini tool box consisting of:  
mini with 3 m lift and 2 m control length in practical transport box incl. 6 m supply hose and couplings





**J.D. NEUHAUS**  
powered by air!

## The JDN mini series for general duty

**Carrying capacities: 125 kg, 250 kg, 500 kg, 980 kg**  
**Air pressure: 6 bar**

The **mini** widens the range of applications in the light duty sector as a handy, flexible and universally deployable hoist making it an ideal tool for a wide range of light/medium manufacturing applications.

### mini Manipulator

With the **mini** manipulator loads can be lifted, lowered, manually traversed and positioned with only one hand. Further information on request.

Explosion Classification:  $\text{Ex}$  II 3 GD IIA T4



## The advantages at a glance

- Price competitive alternative when compared to other types of powered hoists.
- Suitable for lube-free operation.
- Suitable for application in hazardous areas.
- Minimum components for ease of maintenance.
- Wear resistant motor braking system.
- Lightweight for easy handling.
- Also suitable for horizontal pulling.
- Extremely sensitive lever control with emergency shut-off valve, max. control length 6 m.
- Available lifting heights: up to 8 m.
- With chain box as standard.
- With manual trolley as option.

## Technical Data

Type		mini 125	mini 250	mini 500	mini 1000
Capacity	lbs	275	550	1100	2160
	kg	125	250	500	980
Number of chain strands		1	1	1	1
Motor output	kW	0.4	0.4	1	1
Air pressure	PSI	85	85	85	85
	bar	6	6	6	6
Lifting speed without load <sup>1</sup>	ft/min	130	65	65	33
	m/min	40	20	20	10
Lifting speed at full load <sup>1</sup>	ft/min	49.5	26	33	16
	m/min	15	8	10	5
Lowering speed at full load	ft/min	99	52	59	33
	m/min	30	16	18	10
Lowering speed without load	ft/min	78.7	39.4	39.4	19.7
	m/min	24	12	12	6
Air consumption at full load – lifting	cfm	17.5	17.5	42.5	42.5
	m <sup>3</sup> /min	0.5	0.5	1.2	1.2
Air consumption at full load – lowering	cfm	24.7	24.7	56.5	56.5
	m <sup>3</sup> /min	0.7	0.7	1.6	1.6
Air connection		G 3/8	G 3/8	G 1/2	G 1/2
Hose dimension (∅ inside)	inch	0.35	0.35	0.5	0.5
	mm	9	9	13	13
Weight with 10 ft / 3 m lift	lbs	21	23.1	46.2	50.6
	kg	9.5	10.5	21	23
Chain dimension	mm	4 x 12	4 x 12	7 x 21	7 x 21
Weight of chain	lbs/ft	0.23	0.23	0.67	0.67
	kg/m	0.35	0.35	1.0	1.0
Height of lift	ft		10/16/26		
	m		3/5/8		
Length of control at standard lift	ft		6.5/13/20		
	m		2/4/6		
Noise level at full load <sup>2</sup> – lifting	dB(A)	79	79	77	77
Noise level at full load <sup>2</sup> – lowering	dB(A)	80	80	83	83

Group mechanism: M3 (1 Bm)

<sup>1</sup> Lifting speed at 2 m length of control. Longer control hoses decrease the lifting speeds.

<sup>2</sup> Measured at 1 m distance acc. to DIN 45635 part 20

# JDN AIR HOISTS MINI



## Dimensions

Type		mini 125	mini 250	mini 500	mini 1000
A	inch mm	12.9 328	12.9 328	18.0 458	18.0 458
B	inch mm	9.1 232	9.1 232	12.4 316	12.4 316
C	inch mm	14.4 367	14.4 367	19.9 505	19.9 505
D	inch mm	3.6 92	3.6 92	4.8 122	4.8 122
E	inch mm	8.4 213	8.4 213	11.5 292	11.5 292
F	inch mm	4.3 109	4.3 109	5.8 148	5.8 148
G	inch mm	4.1 104	4.1 104	5.6 144	5.6 144
H	inch mm	7 177	7 177	9.2 234	9.2 234
J	inch mm	5.8 148	5.8 148	7.6 194	7.6 194
K	inch mm	3.3 83	3.3 83	4.7 119	4.7 119
L	inch mm	1.1 29	1.1 29	1.6 40	1.6 40
M	inch mm	0.7 19	0.7 19	1.1 28	1.1 28

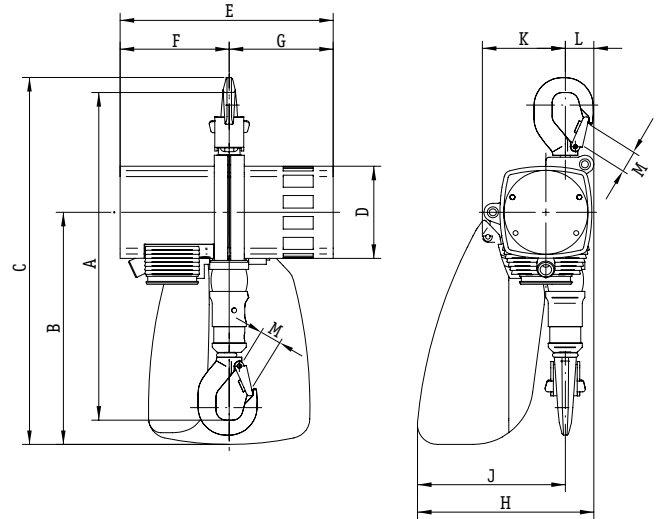

## Manual Trolleys for JDN Air Hoists mini

### Technical Data

Type		LN 250	LN 1000
Capacity	lbs	550	2200
	kg	250	1000
Beam flange width b	inch	2-8	2-8
	mm	50-220	58-220
max. flange thickness t	inch	1.3	1.2
	mm	34	30
min. curve radius	inch	35.4	39.4
	m	0.9	1.0
Weight	lbs	17	21
	kg	7.7	10.5

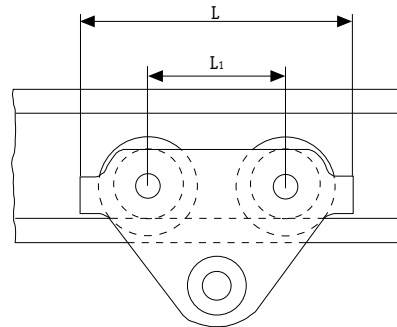

### Dimensions

Type		LN 250	LN 1000
A	inch mm	3.1 79	3.1 79
D	inch mm	0.7 17	0.7 17
D <sub>1</sub>	inch	1	1.2
	mm	25	30
D <sub>2</sub>	inch	1.2	1.4
	mm	30	35
H <sub>1</sub>	inch	1.2	1
	mm	30	25
I	inch	2.7	3.2
	mm	67.5	81.5
L	inch	10.2	10.2
	mm	260	260
L <sub>1</sub>	inch	5.1	5.1
	mm	130	130
O	inch	2.2	2.7
	mm	55	68
T	inch	5.7	5.9
	mm	144	151

